

BTR-24 & TR-24 2.4GHz Wireless Intercom



The RTS RadioCom BTR-24 and TR-24 series intercom is a full-duplex (simultaneous talk and listen) wireless intercom system offering a complete stand alone solution for two (2) to ten users utilizing the full-duplex feature and nearly an unlimited number of listen-only users. The BTR-24 system offers easy setup, durable beltpacks, 64-bit audio encryption, easy system expansion and a three (3) year warranty. The RadioCom BTR-24 system operates utilizing the license free 2.4 GHz IEEE 802.11b Wi-Fi standard.

The BTR-24 system incorporates the option of two (2) individual audio channels selectable at each TR-24 beltpack. The TR-24 beltpacks also provide the user with adjustable volume control, headset microphone level and local sidetone level. The TR-24 operates with dynamic or electret headset microphones and has a built-in lithium-ion battery pack providing up to eight (8) hours of uninterrupted operation.

Upon startup the BTR-24 base station automatically scans and selects the best radio frequency (RF) channel for communication with a feature called ClearScan. The BTR-24 also has a built-in lithium-ion battery pack providing up to ten (10) hours of uninterrupted operation or can be operated with the included wall mount AC power supply for prolonged use. The BTR-24 also includes rack mount hardware.

Features

- License-free operation.
- 64-bit encrypted audio.
- Full-duplex operation.
- Two (2) individual audio channels.
- Automatic RF channel selection via ClearScan.
- Independent volume control and headset mic level control.
- System supports up to 10 beltpacks (full-duplex).
- Easy setup and operation.
- Operates on IEEE 802.11b Wi-Fi standard.
- Operating range up to 800ft, line-of-sight (beltpack to base station).
- Low battery indicators on beltpack and base station.
- Battery charge indicators on beltpack and base station.
- Rack mount for BTR-24 included.
- Independent local sidetone level control.
- Programmable beltpacks for remote group operation.
- Built-in lithium-ion battery packs on BTR-24 and TR-24.

Line Drawings

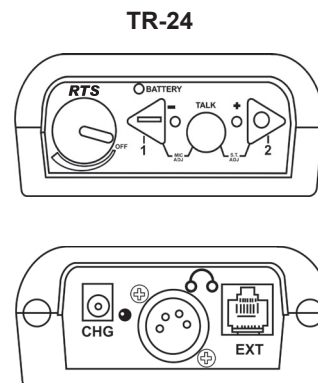
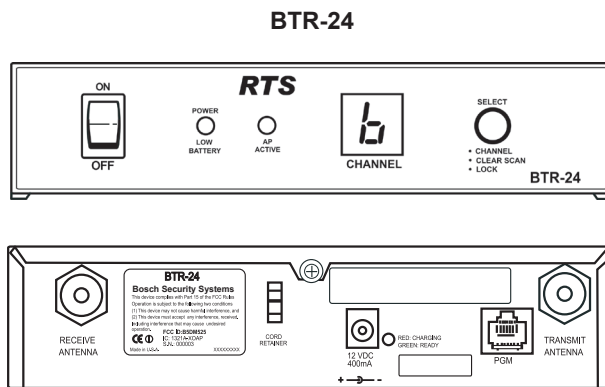

Specifications

Frequency Band of Operation

North America:..... 2.412–2.462GHz (Wi-Fi: Channels 1-11)
 Europe:..... 2.412–2.472GHz (Wi-Fi: Channels 1-13)
 Beltpack Headset Output:..... 70mW into 300Ω
 (1% distortion)
 Technology: 2.4GHz, IEEE 802.11b
 Wireless LAN Standard Wi-Fi
 FCC License:..... None Required (License Free Use)
 Number of Users: 2 to 10 Users per BTR-24 Base Station
 (Full-Duplex)
 Encryption:..... 64-bit (DES) Encryption Key
 Battery Type: Lithium-Ion Rechargeable
 (Base Station and Beltpack)
 Battery Life – BTR-24: 10 Hrs (charge time 10-14 Hrs)
 Battery Life – TR-24: 8 Hrs (charge time 6-8 Hrs)
 Frequency Response: 400Hz to 5500Hz
 Dynamic Range:..... >75dB Antenna supplied
 TR-24 Beltpack:..... Internal Dipoles
 BTR-24 Base Station:..... External TNC-RP Dipoles
 Headsets: Dynamic or Electret Microphone elements
 can be used with TR-24 Beltpack
 Battery Status Indicators: Included on TR-24 and BTR-24
 Charge Status Indicators:..... Included on TR-24 and BTR-24
 Mic Level Adjustment:..... Programmable on TR-24,
 with Voice Prompts
 Local Sidetone Adjustment: Programmable on TR-24,
 with Voice Prompts

Channel Indicators

TR-24 Beltpack:..... Green LED for Audio Channel
 BTR-24 Base Station:..... 7 Segment LED for RF Channel
 Warranty:..... 3 Year Warranty

Product Dimensions/Weight

BTR-24 6.00" L x 7.50" W x 1.72" H
 (15.24cm x 19.05cm x 4.27cm), 2lb 5oz (1.05kg)
 TR-24..... 5.25" L x 3.75" W x 1.68" H
 (13.34cm x 9.53cm x 4.27cm), 13oz (0.37kg)

Shipping Dimensions/Weight

BTR-24
 (Packaged, Includes rack mounts,
 antennas and power supply) 18.20" L x 11.50" W x 3.90" H
 (46.23cm x 29.21cm x 9.91cm)
 5lb 7oz (2.59kg)
 TR-24
 (Packaged, Includes power supply)..... 13.25" L x 9" W x 3.60" H
 (33.66cm x 22.86cm x 9.14cm)
 1lb 13oz (.82kg)
 SYS-243
 (Packaged system, 3 TR-24's, 1 BTR-24, antennas,
 antennas and power supply) 25.30" L x 21" W x 9.30" H
 (64.26cm x 53.34cm x 23.62cm)
 22lbs 3oz (10.12kg)

Order Information

BTR-24 • 2.4 GHz multi-channel wireless base station access point
 TR-24 • 2.4 GHz multi-channel wireless beltpack with A4M headset connector
 SYS-243 • 2.4 GHz multi-channel wireless beltpack and base station system
 PH-100 • Single Sided Headset with A4F connector
 PH-200 • Dual Sided Headset with A4F connector
 HR-1 • Single Sided Headset with A4F connector
 HR-2 • Dual Sided Headset with A4F connector
 PH-1 • Single Sided Headset with A4F connector
 PH-2 • Dual Sided Headset with A4F connector
 RA-3 • Omni Antenna (3 dB), with TNC reverse polarity connector
 RA-7 • Omni Antenna (7 dB), with TNC reverse polarity connector (North America)
 RA-5 • Omni Antenna (5 dB), with TNC reverse polarity connector (North America)
 FP-11 • Flat Panel Directional Antenna (11 dB) with TNC reverse polarity connector
 (North America)
 ANT-FP • Dual Diversity, Flat Patch Antenna (North America)

RPT-3 • 3FT Coax with TNC reverse polarity connector
 RPT-10 • 10ft Coax with TNC reverse polarity connector
 TNC-RP • TNC reverse polarity coupler (jack-to-jack)
 CC-24 • Carry case for BTR-24 system
 LG-Y • Headset Y cable for Telex Legacy
 LG-PS • US power supply for BTR-24 and TR-24
 ANT-FPM • Tilt and Swivel Antenna Mount Bracket
 XOB • Adjustable Nylon Belt
 RA-7E Kit • Omni Antenna (7dB), with TNC reverse polarity connector and coax
 (Europe).
 RA-5E Kit • Omni Antenna (5dB), with TNC reverse polarityconnector and coax
 (Europe).
 FP-11E Kit Flat Panel Directional Antenna (11dB) with TNC reverse polarity connector
 and coax (Europe).
 ANT-FBE Kit Dual Diversity, Flat Patch Antenna and coax (Europe).

For ordering information, contact your regional sales representative at:
<http://rtsintercoms.com/us/intercom/contact>

The specification information is preliminary and is subject to change without
 notification. Brand names mentioned are the property of their respective companies.